



THE
Kenwood

3 BEDROOM HOME

Beautifully designed, The Kenwood is a 3 bedroom semi-detached home which offers a convenient layout for contemporary lifestyles. The hallway leads to a dual aspect lounge with feature picture windows. A stunning kitchen diner and guest cloakroom complete the ground floor.

Upstairs bedroom one with en-suite can be found alongside two further generous bedrooms and the main bathroom.

Outside there is a detached single garage and enclosed rear garden.



ORTON PARK

Twycross, Warwickshire

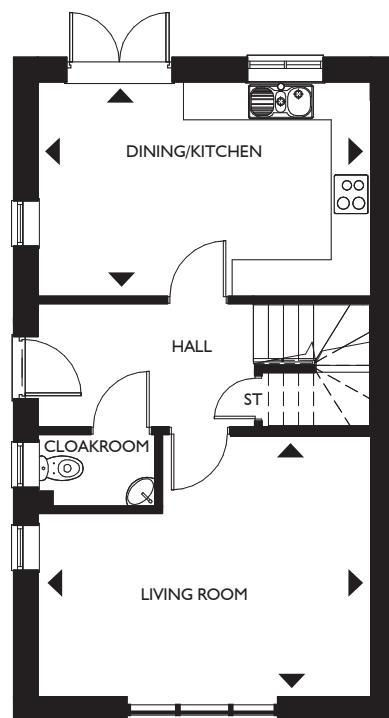

Ground floor

Living Room	4975mm x 3938mm	16'4" x 12'11"
Dining/Kitchen	4950mm x 3210mm	16'2" x 10'8"

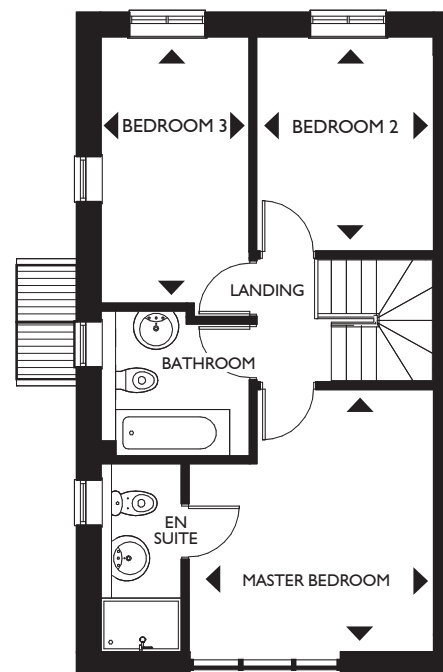

First floor

Master Bedroom	3938mm x 3678mm	12'11" x 12'0"
Bedroom 2	3223mm x 2643mm ^{max}	10'6" x 8'8" ^{max}
Bedroom 3	4000mm x 2232mm	13'1" x 7'3"